

TÜREN MIT FINGERSCHUTZ

Kindertagesstätte Bahnwinkel - Pfinztal - Söllingen













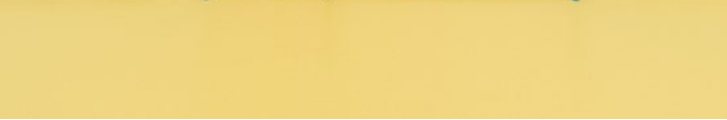









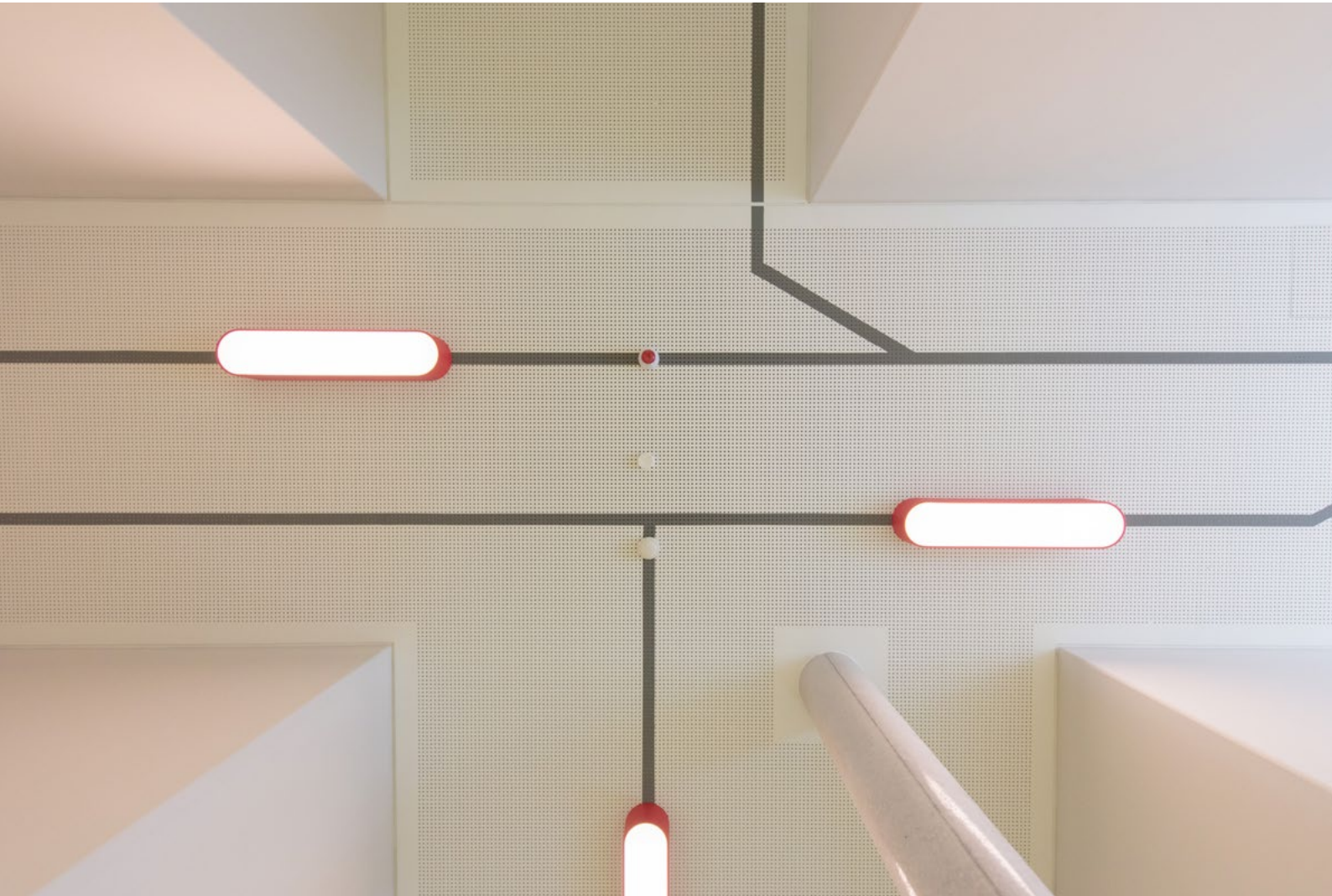











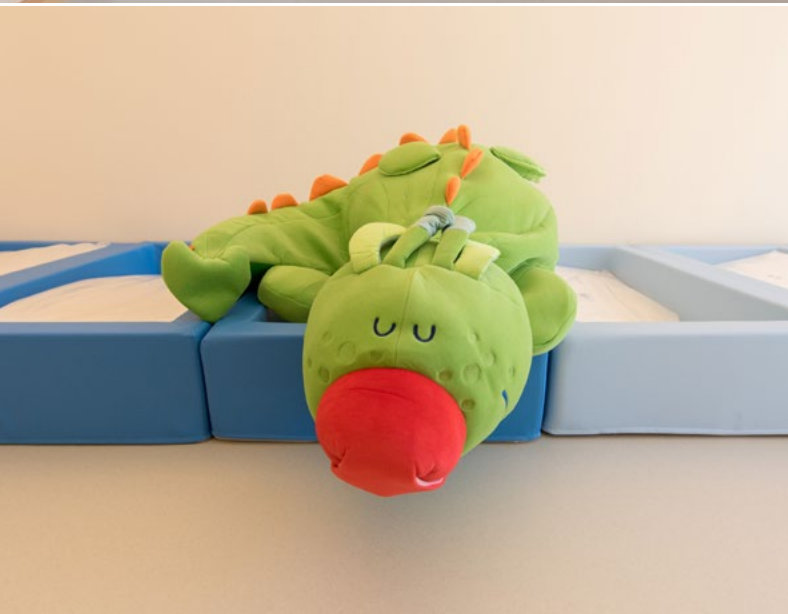





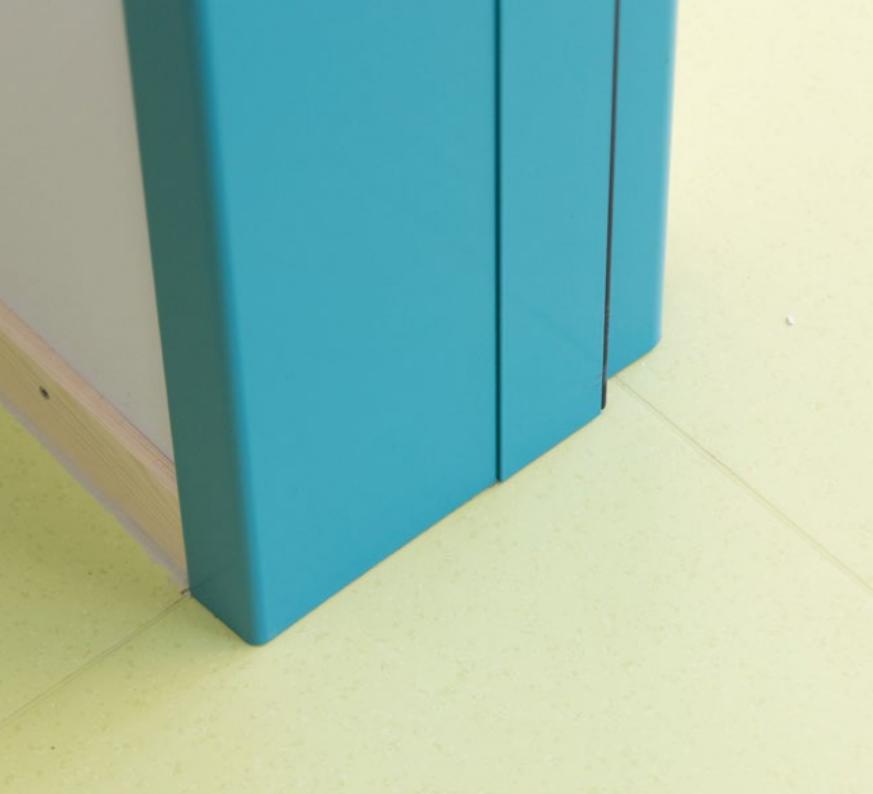



reddot design award
winner 2012



Merkmale Fingerschutztüren

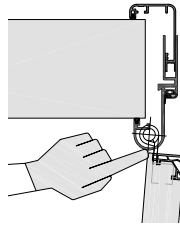

Abgesicherte Scherstellen

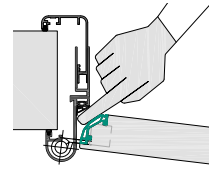

Nachgiebige Knautschzonen

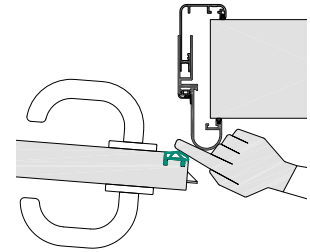

Weiche Türkanten

Modellübersicht - Fingerschutzzargen

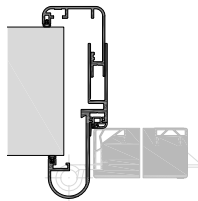

EUROFI
Umfassungszarge

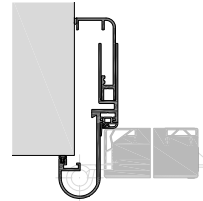

EUROFI-E
Eckzarge

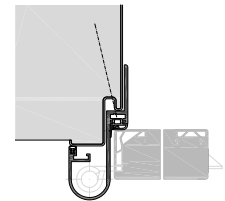

EFI
Renovierungs-Eckzarge
über bestehender Stahlzarge

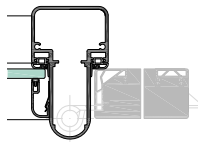

KFI
Pfostenprofil

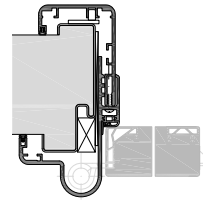

RENOFI
Renovierungszarge

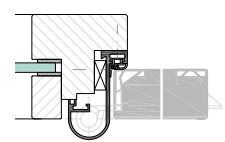

HFI
für Kombination mit
bauseitigem Holzstock

Beispiele Elementaufteilungen

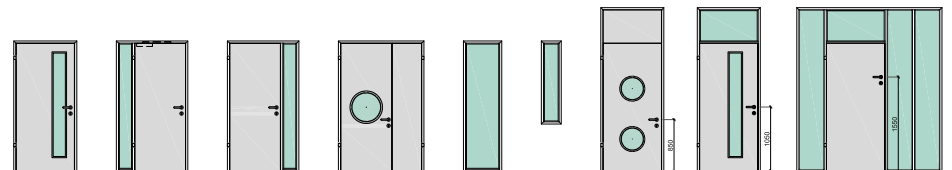



KITA Im Bahnwinkel,
Pfinztal Söllingen



Architekturbüro Stuffer,
Ettlingen



ZEG, Mannheim

Schreinerei Frank Zoller,
Pfinztal



Ralf Kuhn, Küffner Aluzargen

Küffner Aluzargen
GmbH & Co. OHG
Kutschenweg 12
D - 76287 Rheinstetten
fon +49 721 5169 - 0
fax +49 721 5169 - 40
info@kueffner.de
www.kueffner.de

- Aluminiumzargen
- Raumspartüren
- Fingerschutztüren
- Rahmentüren
- Glasverbundelemente
- Sockelprofile
- Aluminiumpaneele
- Mediensäulen und Kanäle